

# 7<sup>th</sup> Floor Layout

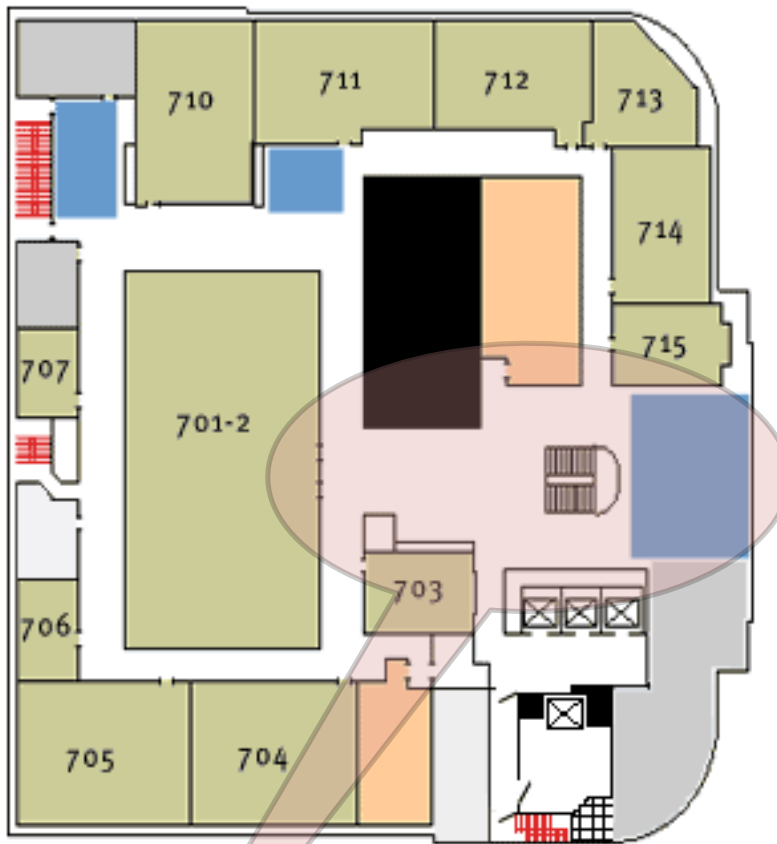

## Table Assignments

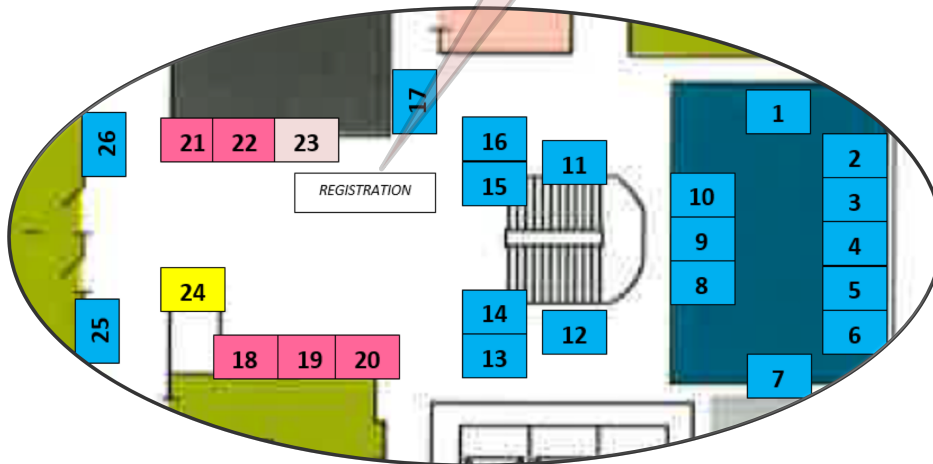

1. All-State Legal
2. Anchin, Block & Anchin LLP
3. Distinctive Office
4. Epiq Global
5. Elite Limousine Plus, Inc.
6. Smart Choice Communications
7. Globe Storage - Moving Co.
8. Herbert L. Jamison & Co., LLC
9. Knoll, Inc.
10. Ivionics
11. Kastle Systems
12. Rippe & Kingston
13. LDI Color ToolBox
14. Robert Half Legal
15. USI Affinity
16. Tabush Group
17. Proxy
18. City National Bank
19. Friedman Williams
20. Canon Solutions America, Inc.
21. Loeb Leadership Development Group
22. Emergency Skills, Inc.
24. Konica Minolta (Empire)
25. 4th Bin
26. Gilsbar Pro

23 - ALA Material/D&I/Membership

27 - LSFN (Special Guest)